

Safety & Environmental Training 2010 Course Catalog



Table of Contents

OSHA Outreach Training	1
OSHA – 10 Hour Construction Industry Outreach Training	1
OSHA – 30 Hour Construction Industry Outreach Training	1
OSHA – 10 Hour General Industry Outreach Training	1
OSHA – 30 Hour General Industry Outreach Training	1
Supervisor Training	1
Fall Arrest Systems	1
Electrical Standards	1
OSHA – Hazardous Waste Training	2
Hazwoper 8 Hour Annual Refresher	2
Hazwoper 24 Hour Course	2
Hazwoper 40 Hour Course	2
OSHA General Industry	2
OSHA Construction	2
Manufacturing And General Industry	3
Personal Protective Equipment	3
Back Injury Prevention/Safe Lifting	3
Chemical And Hazardous Materials	3
Forklift Safety/material Handling	3
Specific Hazards, Machinery	3
Human Resources	3
Public Agency/Public Works/Environment	3
Accommodations - Hospitality: Hotels And Motels	3
Home Health Care	3
Facility Support Janitorial Services	3
Construction Equipment Safety	4
Construction General Safety	4
Construction Hazardous Materials	4
Construction Special Hazards	4
Construction PPE	4
Green Building	5
Environmental	5
Canada Safety Training	5
Construction Project Management Training (Developed with AGC)	5
Electrical Training	5
Hazwoper	5
DOT Courses	5
VU.360 LMS	6
VU.360 LCMS	6

What we offer: Online Safety Training Courses for Construction, Healthcare, General and Manufacturing Industry for OSHA Compliance and Risk Management.

OSHA acceptance: The OSHA Outreach courses have been reviewed and accepted by OSHA for online distribution.

OSHA Outreach Training

OSHA – 10 Hour Construction Industry Outreach Training

This course is designed for construction workers, foremen, job supervisors, and anyone involved in the construction industry. OSHA recommends Outreach Training Program courses as an orientation to occupational safety and health for workers covered by OSHA 29 CFR 1926. Workers must receive additional training, when required by OSHA standards, upon completion of the course. Upon successful completion of the course, participants will receive an OSHA 10-Hour construction Industry Outreach DOL course completion card within 4-6 weeks.

OSHA – 30 Hour Construction Industry Outreach Training

The OSHA 30 Hour Construction Industry Outreach Training course is comprehensive safety program designed for anyone involved in the construction industry. Specifically devised for safety directors, foremen, and field supervisors, the program provides complete information on OSHA compliance issues. OSHA recommends Outreach Training Programs as an orientation to occupational safety and health for workers covered by OSHA 29 CFR 1926. Construction workers must receive additional training, when on the job.

OSHA – 10 Hour General Industry Outreach Training

This course is intended to provide a variety of training on general industry safety and health to entry level workers. Students will be introduced to OSHA policies, procedures and standards as well as general industry safety and health principles covered in OSHA Act Part 1910. Special emphasis will be placed on areas most hazardous using OSHA standards as a guide. Upon successful completion of the course, participants will receive an OSHA 10-Hour General Industry Outreach DOL course completion card within 4-6 weeks

OSHA – 30 Hour General Industry Outreach Training

This course is a comprehensive safety program designed for anyone involved in general industry. Specifically devised for safety directors and field supervisors, the program provides complete information on OSHA compliance issues. OSHA recommends Outreach Training Programs as an orientation to occupational safety and health for workers covered by OSHA 29 CFR 1910. General industry workers must receive additional training, on the specific hazards of the job.

Supervisor Training

Fall Arrest Systems

This 24 Hour course is ideal for Superintendents, Foremen, Safety Coordinators and Directors and Competent persons in the construction industry. Our Fall Arrest Systems course sets forth those requirements and criteria for fall protection in construction workplaces covered under 29 CFR part 1926. It is important to note that the provisions of this subpart do not apply to employees making an inspection, investigation, or assessment of workplace conditions prior to the actual start of construction work or after all construction work has been completed. This course was created in partnership with the Rocky Mountain Education Center (OSHA Training Institute Education Center Region VIII).

Electrical Standards

This 24 Hour course is intended to provide a basic overview of the theory and application of electricity and equations such as Ohm's Law and the Power equation. During this course you will learn the basics of electricity including a detailed discussion of voltage, current, and resistance. You will then learn how each of these elements forms mathematical relationships with one another through the application of these quantities using mathematical equations fundamental to the study of electricity. This course was created in partnership with the Rocky Mountain Education Center (OSHA Training Institute Education Center Region VIII).

OSHA – Hazardous Waste Training

Hazwoper 8 Hour Annual Refresher

This course meets the requirements in OSHA 29 CFR 1910.120 for eight hours of annual refresher training for workers at hazardous waste sites.

Hazwoper 24 Hour Course

The Hazwoper 24 Hour course is required for workers on site only occasionally for a specific limited task.

Hazwoper 40 Hour Course

Hazwoper 40 Hour is required for employees working on a project consisting of Uncontrolled Hazardous Waste Operation mandated by the Government.

Flash-based Courses

General Industry and Construction titles are Flash-enabled

OSHA General Industry

Bloodborne Pathogens
Confined Spaces & Permit Required Confined Spaces
Driver Safety Course for Cars, Vans & Small Trucks
Driver Safety Course for Large Trucks and Buses
Electrical Safety
Emergency Action Plan
Ergonomics for Non-Office Workers
Stand Up Forklift
Formaldehyde Awareness
Hazard Communication
Hazardous Materials
Hazardous Substances and Industrial Hygiene
Hazards of Asbestos in the Workplace
Hazwoper
Introduction to OSHA and the OSH Act
Ionizing & Non-Ionizing Radiation Safety
Lead Safety in the Workplace
Lockout/Tagout
Machine Guarding Safety
Materials Handling and Storage
Motor Vehicles
Occupational Noise Exposure
Personal Protective Equipment
Process Safety Management of Highly Hazardous Materials
Recordkeeping & Reporting
Respiratory Protection
Safety & Health Programs
Sit Down Forklift
Walking & Working Surfaces
Welding, Cutting & Brazing
Workplace Violence
Use of Explosives in the Workplace

OSHA Construction

Basic Safety Orientation
Concrete & Masonry Construction
Confined Space Entry
Cranes & Rigging
Electrical Safety
Excavation Safety
Fall Protection
Fire Safety
Stand Up Forklift
Hand and Power Tools
Hazard Communication
Hazardous Materials
Introduction to OSHA and the OSH Act
Lead Safety in the Workplace
Materials Handling
Motor Vehicles
Occupational Noise Exposure
Personal Protective & Lifesaving Equipment
Process Safety Management of Highly Hazardous Materials
Recordkeeping & Reporting
Respiratory Protection
Scaffolding Safety
Sit Down Forklift
Stairway & Ladder Safety
Struck-By & Caught In Between Hazards
Use of Explosives in the Workplace
Welding & Cutting
Workplace Violence

Video-enabled Courses

Each course has full motion video with a post-test assessment.

Manufacturing And General Industry

Hazardous Energy Source - Lockout/Tagout Affected and
Authorized Persons - Machine Operators/Non-Operators
Orientation 2000 (Long Version)
Hazard Communication - The New Millennium (Short Version)
MSDS for Hazardous Communications
Orientation 2000 Short Version)
Employee Safety Orientation
Workplace Safety Inspection Checklist

Personal Protective Equipment

Bloodborne Pathogens
Personal Protective Equipment
Bloodborne Pathogens for Non-Healthcare Workers
Controlling Exposure to Bloodborne Pathogens
Bloodborne Pathogens & Needle Stick for Healthcare Workers
Bloodborne Pathogens
Hand Injuries - The Gory Story
New Bloodborne Pathogens - The Complete Program
Respirators and How to Use Them

Back Injury Prevention/Safe Lifting

System Lifting 2000 - Back Injury Prevention (Short Version)
Back Injury Prevention
System Lifting 2000 - Back Injury Prevention (Long Version)
Back Injury Responsibility

Chemical And Hazardous Materials

Fire Extinguisher 2000 (Short Version)
Fire Prevention Responsibility
Chemical Safety
Bonding and Grounding of Flammable Liquids Transfers
Hazardous Spill Cleanup
Hydrogen Sulfide Training
Flammables and Combustibles
Hazwoper - Orientation
DOT Shipping of Hazardous Materials

Forklift Safety/material Handling

Forklift Operator Training
Aerial Lift Safety
Forklift Instructor Training
Electric Pallet jack
Safety of People and Equipment in Warehouse Operations
Propane Safety
Forklift "The New Rules"
Forking Around
Forklift Update for Experienced Operators

Specific Hazards, Machinery

Safe Operation of Overhead Cranes and Hoists
NFPA 70E Electrical Safety - Arc Flash Safety for Employees
Chains, Cranes, Hoist, and Slings (Updated)
Confined Space Entry *Updated
High Voltage Electrical safety
Hand and Power Tool Safety
Portable Grinders and Abrasive Wheels
Machine Guarding and Conveyor Safety
Confined Space : The Silent Killers *Updated
Machine Guarding Responsibility *Updated

Human Resources

Sexual Harassment in the Workplace
Sexual Harassment - What Employees Need to Know
Chemical Dependency
(HIPAA) Health Insurance Portability and Accountability Act

Public Agency/Public Works/Environment

Landscape Maintenance
Chain Saw Safety Tree
Trimming Safety
Commercial Mower Safety

Accommodations - Hospitality: Hotels And Motels

Human Behavior - Reducing Unsafe Acts *Updated
Laundry Room Safety Basics
Lockout/Tagout *Updated
Fire Extinguishers Training *Updated
Back Injury Prevention *Updated

Home Health Care

Universal Precautions - Infection Control Procedures
Back Safety for Health Care Providers
Safety Orientation - Nursing
How to Prevent Slips and Falls

Facility Support Janitorial Services

Hazard Communications (Janitors/Custodians) Updated
Safety Orientation and Accident Prevention
Bacteria and Disease Control
Taking Care of Your Equipment and Supplies
Electrical Safety (Janitors/Custodians)
Floor Cleaning Tips

Video-enabled Courses

Each course has full motion video with a post-test assessment.

Construction Equipment Safety

Backhoe/Loader Operations *Updated
Scaffolding Safety for Employees
Ladder Safety
Hand and Power Tool Safety
Forklift Operator Safety
Dump Truck Safety *New Update*
Portable Grinders and Abrasive Wheels

Construction General Safety

General Safe Work Practices
Preventing Injury Incidents
Lifting Safely in Construction
Basic Electrical Safety in the Workplace *Updated
Slips and Falls in Construction
Fire Extinguisher 2000
Accidents - "It Can't Happen to Me"
Safety is Your Responsibility

Construction Hazardous Materials

Hazardous Communications "Your Right to Know"
(Construction) Updated
Health and Safety Factors in Welding Operations
Testing and Monitoring for Hazardous Gases
Hazardous Material Spill - Clean Up

Construction Special Hazards

Trenching - Shoring
Confined Space Entry
Flagger Safety *Updated
Safe Operations of Motor Vehicles
Supervisor Safety Responsibilities
Bloodborne Pathogens (Construction)

Construction PPE

Employee Fall Protection
Heat Stress Awareness and Prevention (Updated)
Personal Protective Equipment
Hearing Conservation
Respirators and How to Use Them

Flash-based Courses Continued

Green Building

Residential Green Building: Design, Construction, Certification
Commercial Green Building: Guidelines, Process, Best Practices
Green Building for Infrastructure
Green Building for Commercial Applications

Environmental

California 8-Hour Overview
IATA Refresher Part 1 - CFR 49
RCRA in Day to Day Operations
The Clean Air Act
RCRA: What the Law Requires
RCRA 8-Hour Overview
Stormwater Discharges and Permits
Hazardous Waste Principles & Identification
Clean Water Act & Day to Day Operations
EPCRA
Health Effects of Asbestos
Legal Liabilities of Asbestos Inspectors
Spill Prevention and Release Reporting
The Clean Water Act
Spill Prevention, Control, and Countermeasure

Canada Safety Training

Accident Investigation
Electrical Safety
Emergency Action Plan
Ergonomics for Non-Office Workers
Fire Safety
Hazard Communication
Hand & Power Tools
Machine Guard Safety
Personal Protective Equipment
Stairway & Ladder Safety
Transportation of Dangerous Goods
Whmis*
Whmis Train The Trainer
Workplace Violence

Construction Project Management Training (Developed with AGC)

Equipment Utilization for Project Managers
Conducting Effective Meetings
Preplanning
Short Interval Planning (SIP)
Written Communications
Underlying Studies for Heavy/Civil Construction
Underlying Studies Building Construction

Electrical Training

NFPA 70E
NEC 2008 Code Update
NEC 2008 Grounding and Bonding
NEC 2008 Wiring and Protection
Electrical Fundamentals

Hazwoper

Hazwoper: Regulation Overview
Hazwoper: Site Characterization
Hazwoper: Toxicology
Hazwoper: Hazard Recognition
Hazwoper: Decontamination
Hazwoper: Medical Surveillance
Hazwoper: Emergency Procedures
Hazwoper: Site Control

DOT Courses

What DOT Supervisors Need to Know About
Reasonable Suspicion Testing
What DOT Employees Need to Know about
Reasonable Suspicion Testing*

*coming soon



VU.360 LMS

The VU.360 LMS platform manages the delivery, tracking and measurement of your compliance, licensing and certification training requirements. Designed to work in tandem with Company Name's extensive compliance and licensing e-learning library, VU.360 can also be extended to host your proprietary learning content and assessments.

As a fully web-hosted solution the VU.360 LMS requires no set-up or implementation and is provisioned for your use immediately upon

VU.360 LMS features:

- On-demand and immediate access
- Fully web-hosted and secure
- Learner and manager modes
- Hierarchy and roles-based user management
- Bulk or group-based registration
- Batch user imports
- Self-guided or assigned enrollments
- Training plan management
- Survey creation, distribution and measurement
- Custom reporting wizard and favorites

VU.360 LMS benefits:

- Rapidly meet compliance mandates
- Document regulatory compliance
- Minimize training delivery costs
- Improve workforce productivity
- Centralize tracking and reporting
- Standardize procedures and processes
- Measure and monitor competencies

VU.360 LMS is optimized for:

- Continuing education programs
- Pre-licensing education
- Licensing exam preparation
- Corporate ethics and compliance
- Certification and skills training
- Stand alone testing and assessments

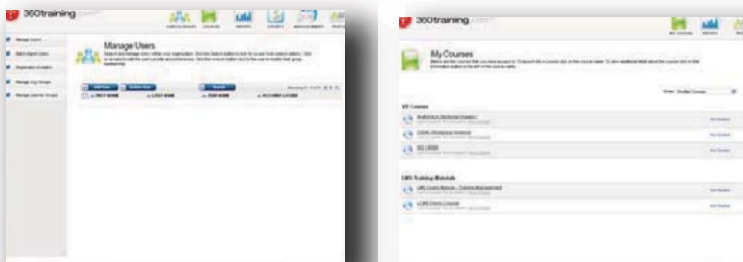

VU.360 LCMS

The VU.360 Learning Content Management System (LCMS) is a desktop application tool designed for authoring, editing, managing, and publishing e-learning content. The LCMS enables instructional designers and course authors to rapidly develop and prepare content for delivery to any market-place or audience. LCMS manages version control and publishes SCORM compliant courseware in a variety of formats including static HTML, multimedia and audio casts.

The primary media assets that can be stored and managed in the LCMS include JPEGs, GIFs, MP3s, Flash files (source and compiled), raw text and MPEG movies. All targeted delivery formats are published in a run-time engine that allows learners to "play" the content using an included Interactive Courseware Player (ICP).

VU.360 LCMS Features:

- Template-driven course authoring
- Delivery of web-enabled media assets
- **Private label player branding**
- **Robust assessment engine**
- Regulatory compliance rules management
- **Flash-based interactivities**
- **Team authoring and collaboration**

VU.360 LCMS Benefits:

- Use default templates to rapidly author courses
- No programming skills required
- Standardize authoring procedures and processes
- Improve work force productivity & collaboration

VU.360 LCMS is Optimized for:

- **Instructional designers**
- **Subject matter experts**
- Collaborative authoring teams
- Proprietary school owners

